

ISSUE HISTORY OF M003730

ISSUE	ECO NO	DESCRIPTION OF CHANGE	BY	ISSUE DATE
01	N/A	PROTOTYPE RELEASE	SP	___/___/___

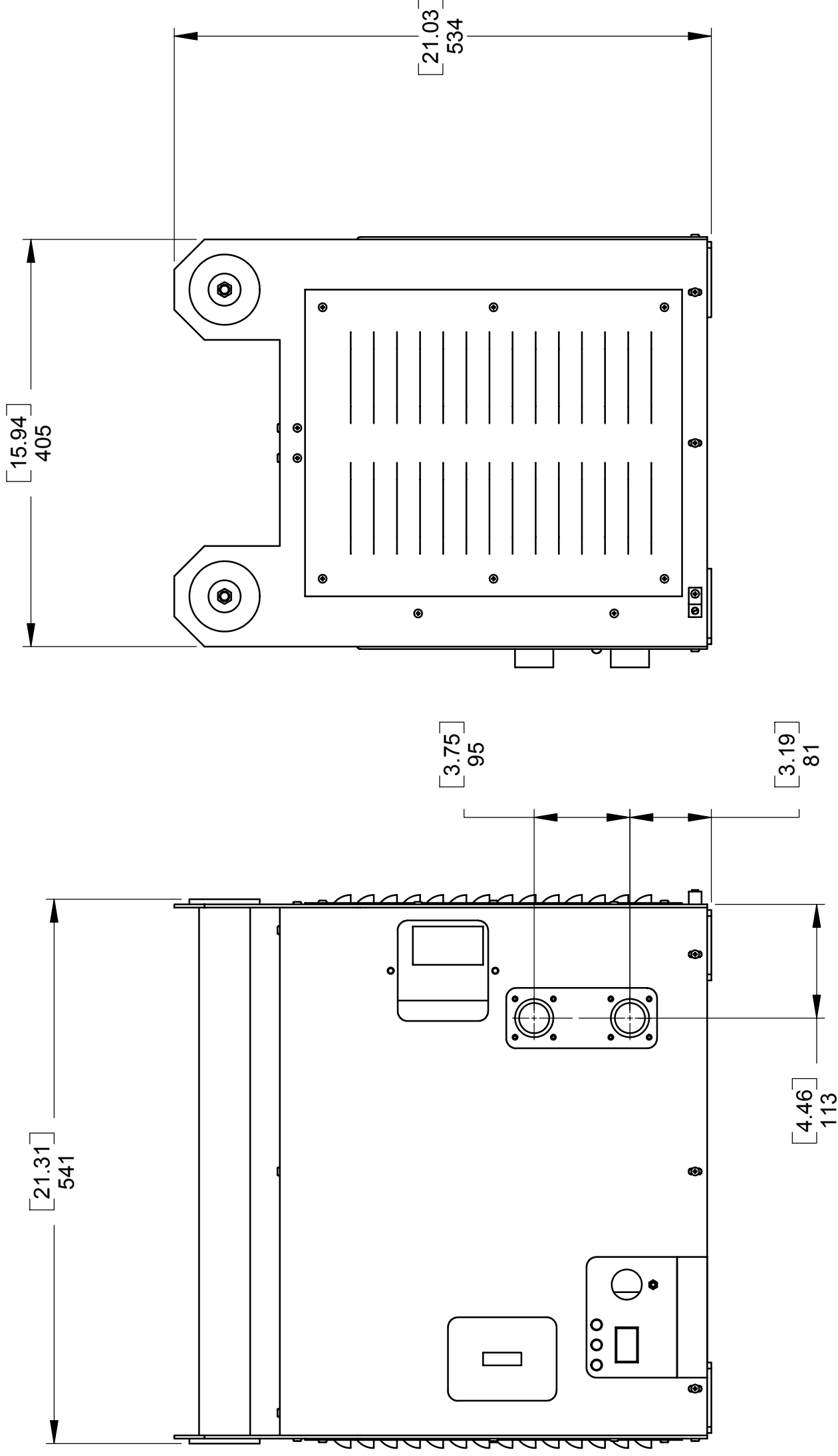

UNITS	INCHES	MILLIMETRES	<input checked="" type="checkbox"/>
UNLESS OTHERWISE SPECIFIED			
INTERPRET DIMENSIONS AND TOLERANCES PER ASME Y14.5M-1994			
ALL DIMENSIONS SHOWN APPLY BEFORE PLATING AND COATINGS			
TOLERANCES APPLY AS SHOWN BELOW			
DECIMAL PLACES	INCHES	MILLIMETRES	
.XXX	± .005	± 0.1	
.XX	± .010	± 0.3	
.X	± .020	± 0.5	
ANGULAR DIMENSIONS			
XX°	± 0.5°		
XX.X°	± 0.1°		
SURFACE ROUGHNESS	MICROINCH	MICRON	
	63	1.6	

USED ON: XP2000	CAD MAINTAINED DATA
CHANGES SHALL BE INCORPORATED ELECTRONICALLY	
PROPRIETARY	
NOT TO BE DISCLOSED OR REPRODUCED IN ANY MANNER WITHOUT THE EXPRESS WRITTEN PERMISSION OF CHRISTIE DIGITAL SYSTEMS INC	
THIRD ANGLE PROJECTION	

PROTOTYPE APPROVAL		SIGNATURE	
FUNCTION	NAME	S. PERSAD	MANUFACTURER
DRAWN BY	SPERSAD		
DESIGNER	SPERSAD		
MATERIAL QUALITY	D. LENZ		
PRODUCTION APPROVAL		SIGNATURE MANDATORY	
FUNCTION	NAME	N/A	N/A
CHECKED(MECH)		N/A	
CHECKED(OPT)		N/A	
CHECKED(ELEC)		N/A	
CHECKED(PROD)		N/A	
APPROVAL DATE		04-21-2004	

CHKISTIE		809 WELLINGTON STREET NORTH KITCHENER, ONTARIO, CANADA N2G 4Y7	
PART DESCRIPTION 7KW BALLAST ENCLOSURE			
SIZE	PART NUMBER	ISSUE	
B	M00373001		
SCALE	MASS	SHEET	OF
1:5	21.77 LBS[9.87 KG]	1	2



CAUTION:
300VAC or 400VAC SWITCH
200 VAC → 400 VAC
INTERNAL (INPUT/POWER RANGE SWITCH)
MUST MATCH INCOMING POWER. REMOVE
COVER TO SET FOR 200 VAC or 400 VAC.
REFER TO PRODUCT DOCUMENTATION.

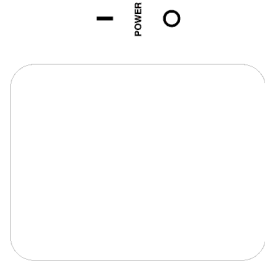

Ø 1 Ø 2 Ø 3

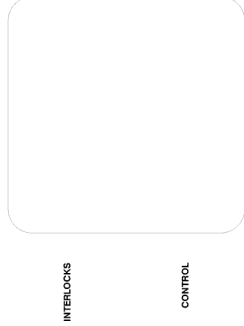

CONTROL

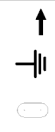

PROPRIETARY
NOT TO BE DISCLOSED OR REPRODUCED IN ANY
MANNER WITHOUT THE EXPRESS WRITTEN
PERMISSION OF CHRISTIE DIGITAL SYSTEMS INC



SIZE **B** PART NUMBER
SCALE 1:5

ISSUE **M003730 01**
MASS 21.77 LBS[9.87 KG] SHEET 2 OF 2